

Actuator, Klappenstellantrieb, Электропривод, Servophon

DA10S..., DA15S...

LUFBERG
CONSTRUCTIVE DECISIONS

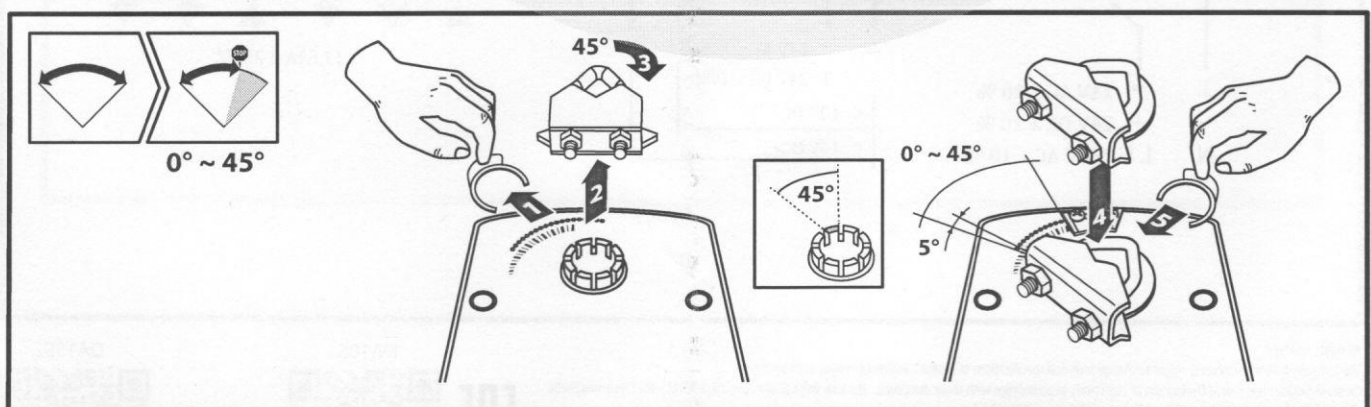
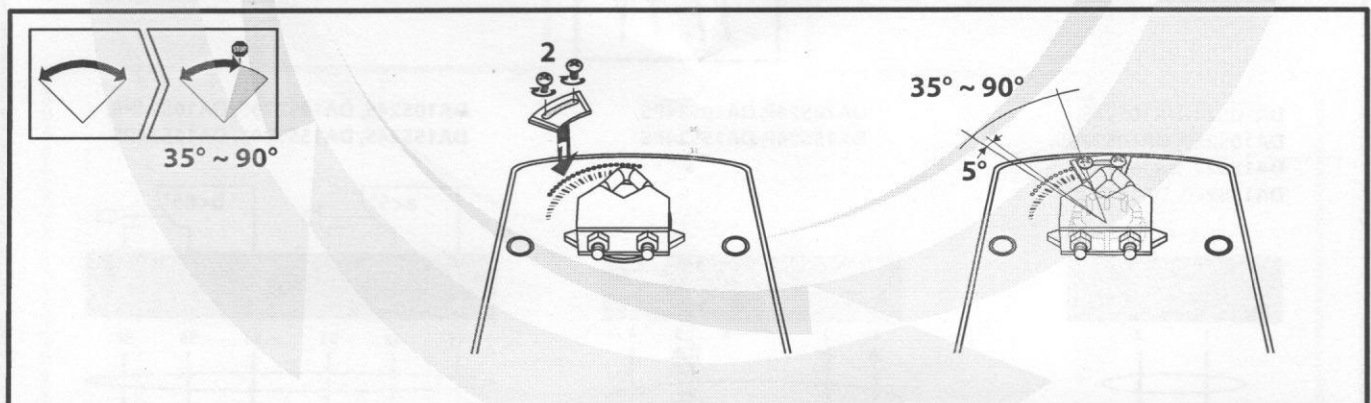
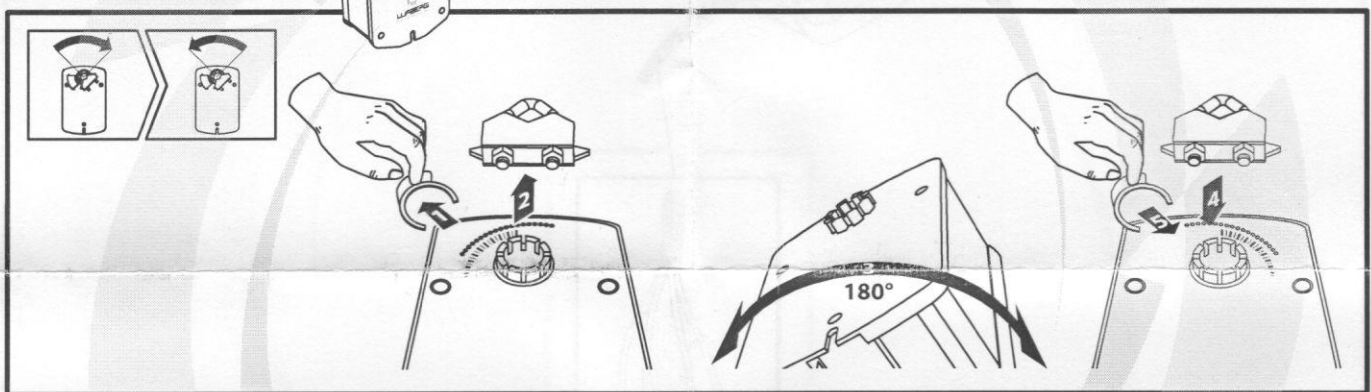
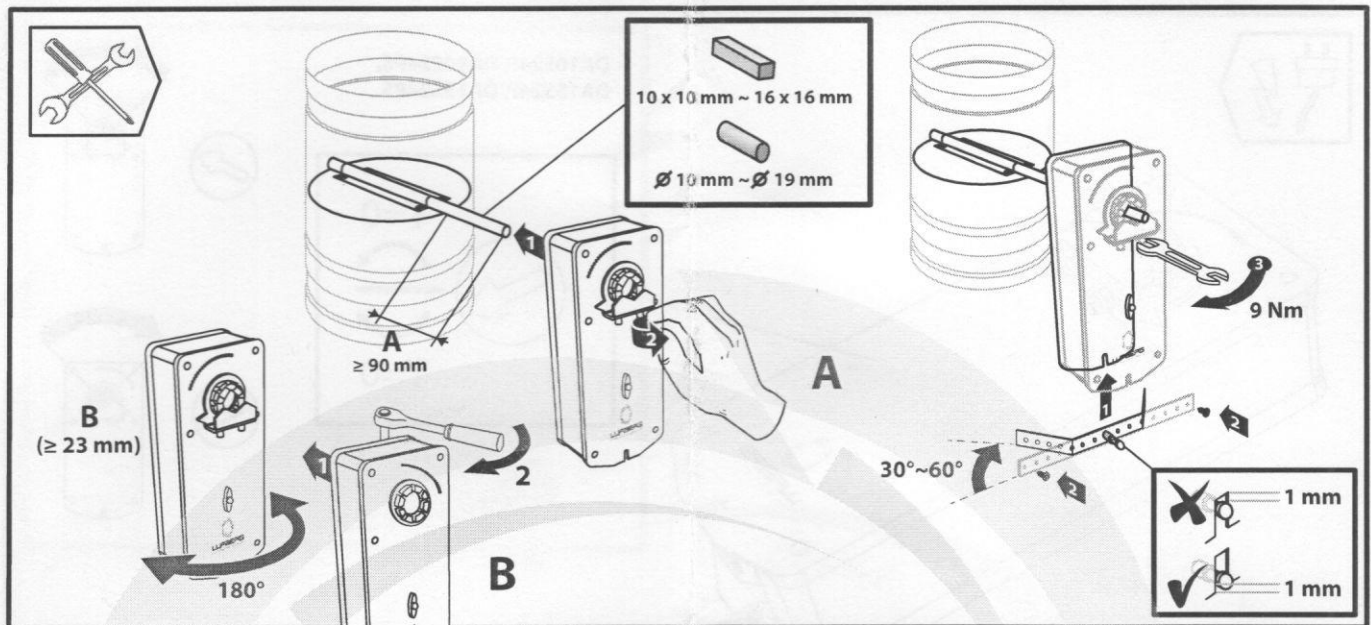

Actuator, Klappenstellantrieb, Электропривод, Servomotor

DA10S..., DA15S...



LUFBERG
CONSTRUCTIVE DECISIONS

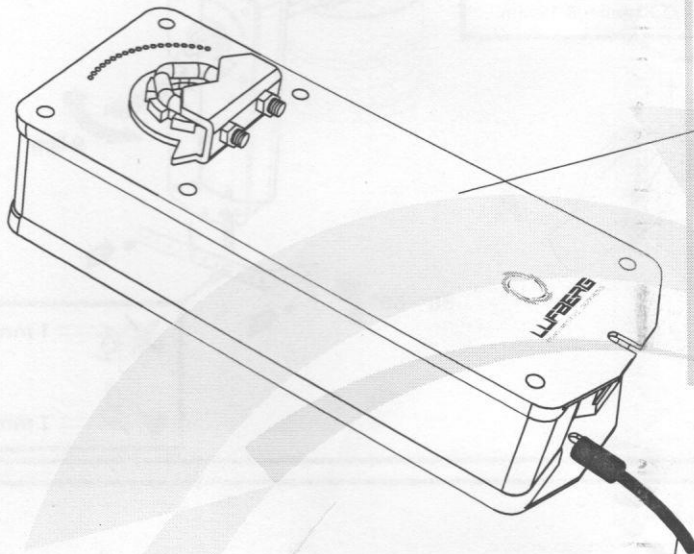
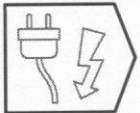

DA10S24P, DA10S24PS,
DA15S24P, DA15S24PS

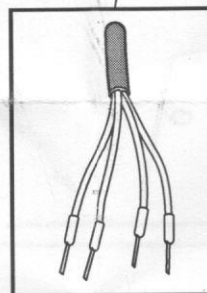
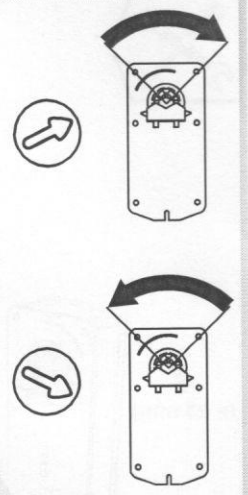
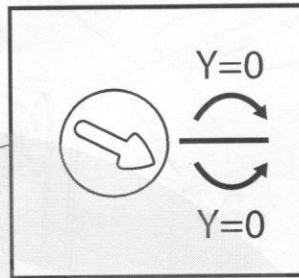

DA10S24, DA10S24S,
DA10S220, DA10S220S,
DA15S24, DA15S24S,
DA15S220, DA15S220S

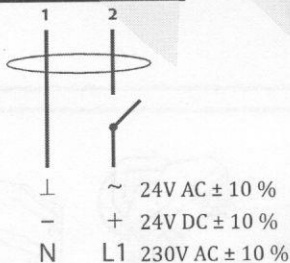

DA10S24P, DA10S24PS,
DA15S24P, DA15S24PS

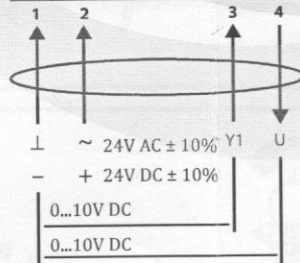

DA10S24S, DA10S220S, DA10S24PS,
DA15S24S, DA15S220S, DA15S24PS

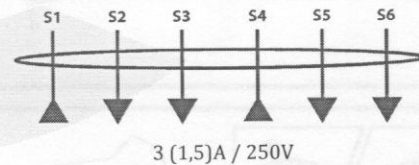
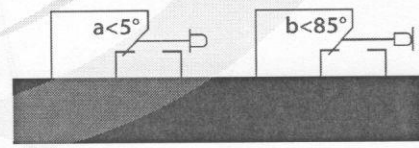

All rights reserved.
 The company Lufberg reserves the right to change technical specifications of product without previous announcement.
 On these product was issued Declaration of conformity in accordance with those directives: the Low Voltage Directive 2006/95/EC, the Electromagnetic Compatibility Directive 2004/108/EC and Machinery Directive 2006/42/EC
 Lufberg s.r.o., Pernerova 780, 56501, Chocen, Czech Republic E-mail: info@lufberg.eu
 Импортёр в РФ: ООО "ВЕНТ ИМПЕКС", Российская Федерация, 197342, г. Санкт-Петербург, набережная Черной речки, д.41, лит.В, помещение 47Н, ч.9, E-mail: vent.impex@mail.ru

www.lufberg.eu

DA10S...



DA15S...

